

# SSSI – GRADE 150 ANCHOR

DOUBLE CORROSION PROTECTION (DCP)

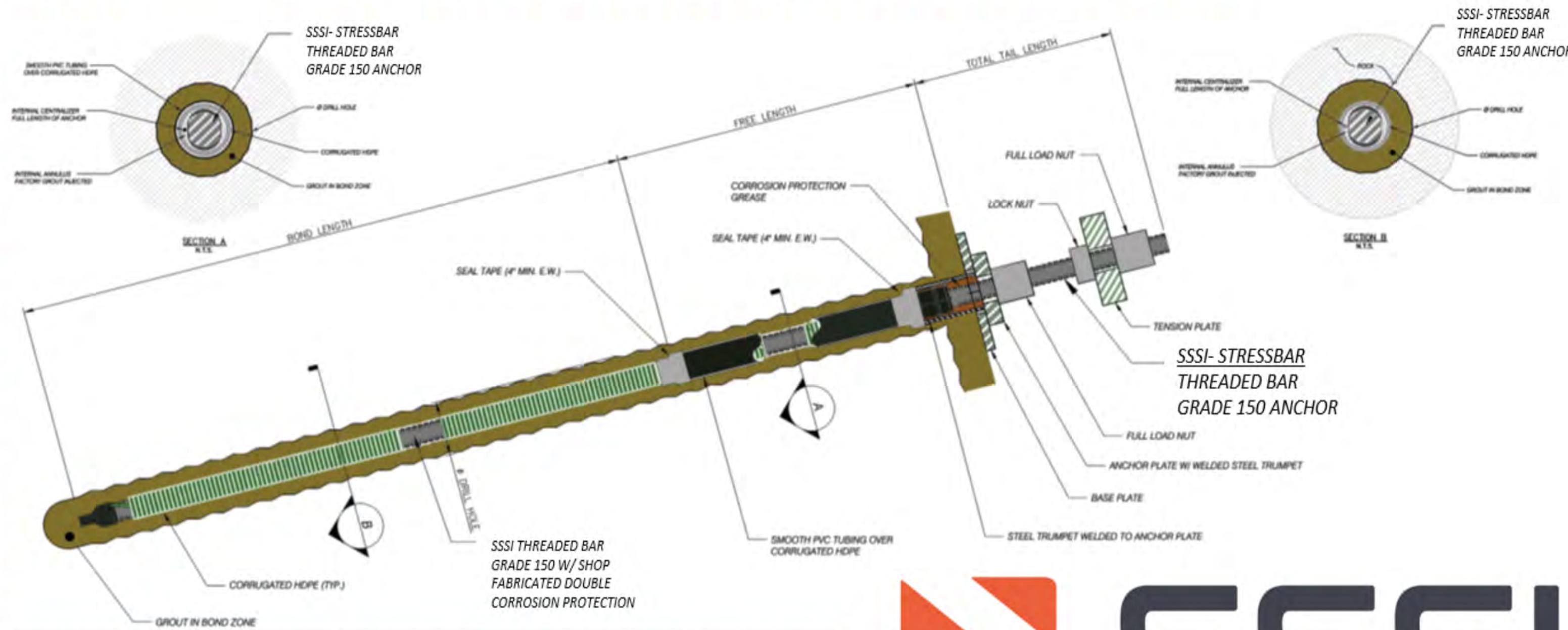

Size		Area		DCP Weight		Yield Load		Ultimate Strength	
[in]	[mm]	[in <sup>2</sup> ]	[mm <sup>2</sup> ]	[lbs/ft]	[kg/m]	[kips]	[kN]	[kips]	[kN]
1"	26	0.85	548	6.24	9.31	102	453	127	565
1-1/4"	32	1.25	806	7.13	10.63	150	667	188	836
1-3/8"	36	1.58	1019	7.81	11.65	190	845	237	1054
1-3/4"	46	2.69	1735	14.8	22.07	323	1435	403	1792
2-1/4"	57	4	2581	16.5	24.62	480	2135	600	2668
2-1/2"	65	5.16	3331	20.59	30.72	620	2757	774	3442
3"	75	6.85	4418	30.95	46.16	822	3656	1028	4572



# SSSI

Stressbar Steel Systems International

HEADQUARTERS: 6001 Bordentown Avenue Sayreville | NEW JERSEY | 08872  
 DISTRIBUTION PLANT: 482 NORDHOFF PLACE ENGLEWOOD, NJ 07631  
 P: 201.366.0974 | F: 201.366.0971  
[www.stressbarsystems.com](http://www.stressbarsystems.com)